

UK-30 MineTruck

UK-30 MineTruck is specially designed wheel type underground transporting equipment. It works with underground wheel loader or mucking loader to transport mine rocks and other materials, it highly improves the transporting efficiency.

UK-30 MineTruck use diesel engine power, hydraulic-mechanic power transfer, 4 wheel drive, front-view seated, rear dump wagon box, central articulation, two cylinder support steering system; it is suitable for medium size tunnelling.

- Powertrain adopts VOLVO PENTA or CUMMINS water-cooled diesel engine.
- The driveline adopts DANA transmission and converter, Kessler SAHR brakes with limit spin, and cut resistance mine tires.
- Trammig brake adopts multi-discs spring-pressed brake, hydraulic release system; with MICO charging and braking valve;
- Parking brake adopts the spring brakes integrated on the Kessler drive axles;
- Chassis: central articulated frame, with front axle oscillating to improve the adhesiveness of the truck to the ground;
- Steering system: Dual hydraulic circuit, dual cylinder supported hydraulic power steering system;
- Wagon box: rear dumping wagon box;
- Cab: sealed cab with heater and cooling air-conditioner.
- Travel aid: 360° travel aid system;
- Fire suppression system: German Batec fire suppression system for engine compartment.

Main Technical parameter	
Payload	30 metric ton
Complete weight	65 metric ton
Wagon box volume	12~16.8 m ³
Size	
Length in transport	10980 mm
Width without tail board	2660 mm
Width with tail board	2890 mm
Height (wagon box)	2450~2850 mm
Height (wagon box unload)	5300 mm
Maximum unload angle	65°
Height (cabin)	2650 mm
Turning radius	
External	8975 mm
Inner	5135 mm
Steering angle	±40°
Ground clearance	394 mm
Grade ability (full load)	25%
Action time	
Wagon box lifting	14 sec
Wagon box descent	12 sec
Maximum traction force	350 kN

Tramming speed	
1st Gear	6.3 km/h
2nd Gear	11.3 km/h
3rd Gear	19.8 km/h
4th Gear	34.8 km/h

PowerTrain	
Engine	VOLVO PENTA
Model	TAD1352/3VE (tire 3), TAD1342VE (tire 2)
Engine power	315/345kW@1900rpm, 310kW/2100rpm
Starting method	Electric starter
Exhaust Purifier	Catalytic purifier+Silencer
Throttle controller	Williams

Options: Cummins engine

Driveline	
Transmission	DANA 6000 Series
Torque converter	CL8000 series
Drive axles	Kessler+CO D106 with limit spin
Ratio	30.2
Tires	26.5-25 inflation tires

Braking hydraulic system	
Braking pump	P2075/2025
Displacement	75/33ml/r
Peak braking hydraulic pressure	20 MPa
Traveling brake	Wet multi-discs spring-pressured brakes
Brake valve	MICO GL820-161-138(ZL)
Working pressure	138 bar
Parking valve	RA3/3/2/G-3

Steering Hydraulic system	
Type	Central articulation, all hydraulic steering
Steering pump	P2075/2025
Displacement	75 ml/r
Steering system peak pressure	22 MPa
Steering device	BZZ-1000
Steering cylinder×2	φ150/φ90 mm

Service hydraulic system	
Service directional valve	M200LS
Lifting cylinder×2	φ180/φ125 mm
Peak pressure	22 MPa

Electric system	
System voltage	24V DC
Engine starter motor	24VDC/6KW
Lighting	
Head light×2	65W@24VDC
Tail light×2	65W@24VDC
Mining signal light×1	24VDC
Ceiling light×1	24VDC

Liquid fill-in	
Hydraulic oil tank	380 Liter
Diesel tank	380 Liter
Transmission	72 Liter
Drive axle main differential ×2	32 Liter
Wheel hub reducer ×4	6.5 Liter

Dimensions

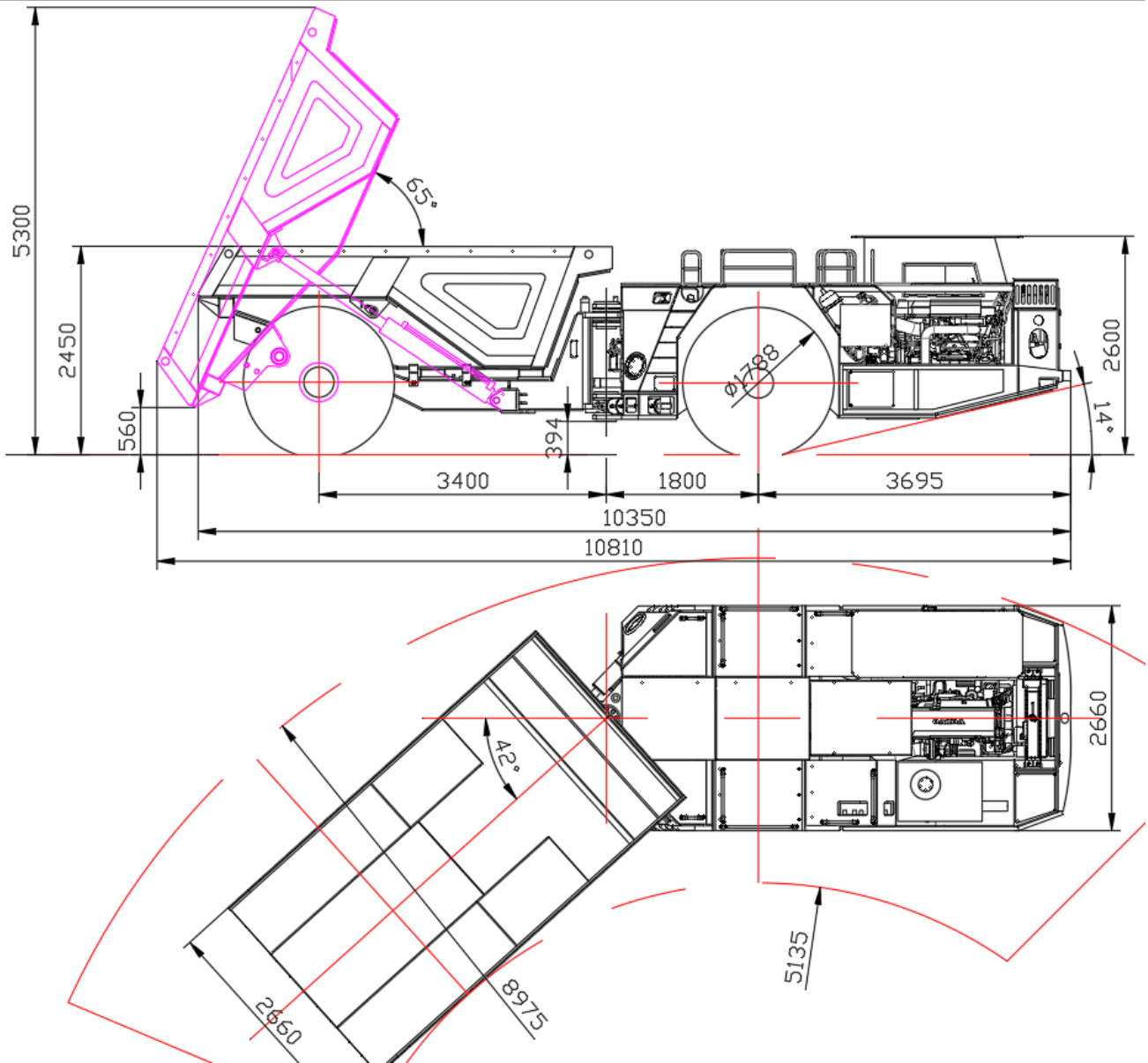

PICTURE FOR REFERENCE:

Cabin with ECU/VCU control system, air-conditioner;







✓ Commissioning



✓ **Maintenance intervals for 2000 hours**

MATERIALS/INTERVAL (hours)	50	100	250	500	750	1000	1250	1500	1750	2000	QTY
OIL FILTER	✓		✓	✓	✓	✓	✓	✓	✓	✓	9
FUEL FILTER	✓		✓	✓	✓	✓	✓	✓	✓	✓	9
WATER-OIL SEPARATOR FILTER ELEMENT	✓		✓	✓	✓	✓	✓	✓	✓	✓	9
HIGH PRESSURE FILTER ELEMENT			✓	✓	✓	✓	✓	✓	✓	✓	8
ENGINE AIR FILTER ELEMENT	✓		✓	✓	✓	✓	✓	✓	✓	✓	8
TRANSMISSION FILTER	✓			✓		✓		✓		✓	5
RETURN FILTER ELEMENT			✓	✓	✓	✓	✓	✓	✓	✓	8
SUCTION FILTER FOR WORK SYSTEM						✓		✓		✓	3
SUCTION FILTER FOR BRAKE SYSTEM						✓		✓		✓	3
FUEL SUCTION FILTER						✓		✓		✓	3
ENGINE OIL	✓		✓	✓	✓	✓	✓	✓	✓	✓	
TRANSMISSION OIL						✓				✓	
HYDRAULIC OIL						✓				✓	
COOLANT											
DIFF OIL		✓				✓				✓	

✓ **Warranty Policy**

- 1 Year or 2000 engine hours after commissioning
- 2000 hours consumable spare parts sent with delivery to the site.